



BASEPLATE KIT INSTALLATION INSTRUCTIONS

KIT# 1167-1

03/11/08
KS

ROADMASTER, Inc. 6110 NE 127th Ave. Vancouver, WA 98682 1-800-669-9690 fax 360-735-9300 www.roadmasterinc.com

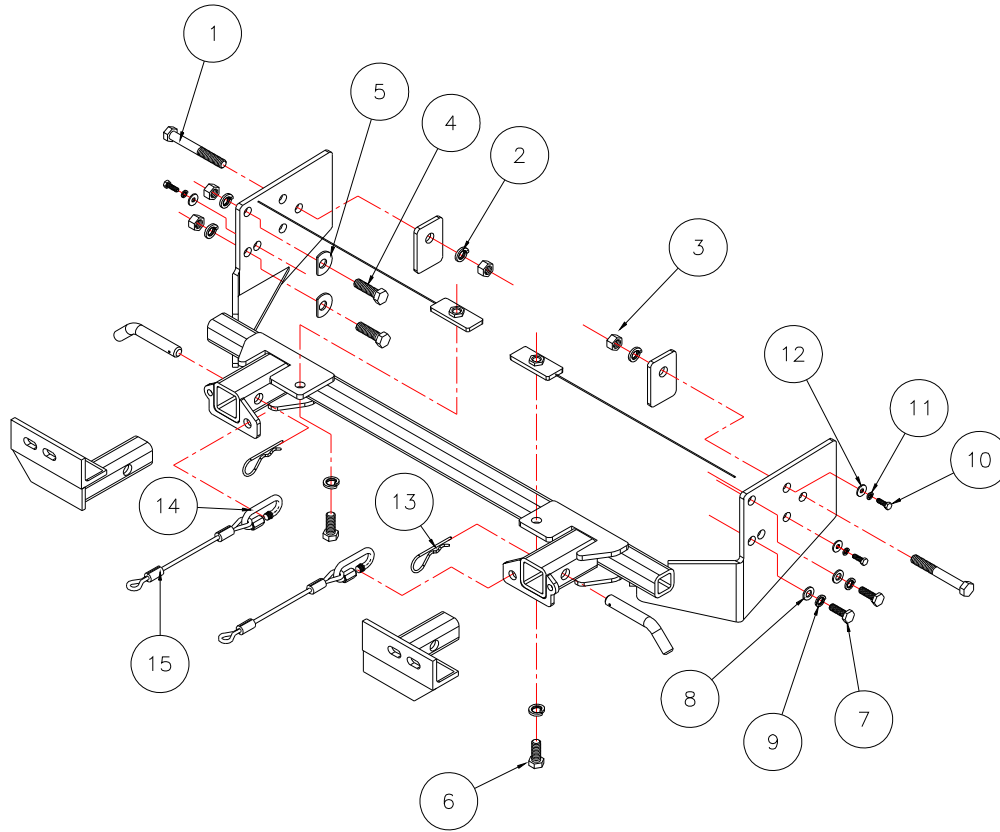

Item	Qty	Length	Width	Hardware	Part No.
1	2	4"	1/2"	1/2" x 4" BOLT	350105-00
2	6		1/2"	1/2" LOCK WASHER	350309-00
3	4		1/2"	1/2" NUT	350258-00
4	2	1 3/4"	1/2"	1/2" x 1 3/4" BOLT	350096-00
5	2		1/2"	1/2" CLIPPED WASHER	350308-20
6	2	1 1/4"	1/2"	1/2" x 1 1/4" BOLT	350361-00
7	2	30MM	10MM	10mm x 1.25 x 30mm BOLTS	356201-00
8	2		10MM	10mm FENDER WASHER	355710-00
9	2		10MM	10mm LOCK WASHER	355715-00
10	3	25MM	6MM	6mm x 1.0 x 25mm BOLT	355894-00
11	3		6MM	6mm LOCK WASHER	355761-00
12	3		6MM	6mm FENDER WASHER	355755-00
13	2			DRAWPIN/SPRINGPIN	357035-00
14	2			CABLE CONNECTOR	200008-00
15	2	8"		SAFETY CABLES	500646-08



BASEPLATE KIT INSTALLATION INSTRUCTIONS

KIT# 1167-1

03/11/08

KS

ROADMASTER, Inc. 6110 NE 127th Ave. Vancouver, WA 98682 1-800-669-9690 fax 360-735-9300 www.roadmasterinc.com

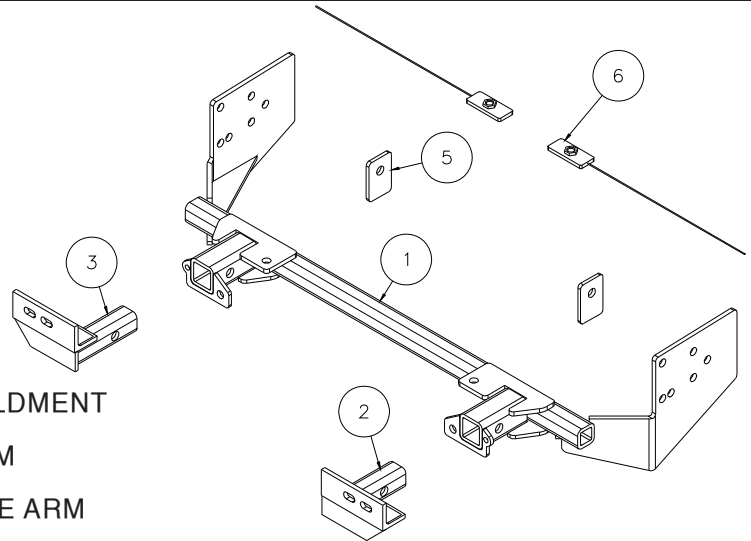

Item	Qty	Part No.	Assembly
1	1	C-000563	MAIN BRACE WELDMENT
2	1	C-000564	DRIVER SIDE ARM
3	1	C-000565	PASSENGER SIDE ARM
5	2	A-000978	2" X 3" BACKING PLATE
6	2	C-000568	1 1/4" X 3" THREADED BACKING PLATE

IMPORTANT: All baseplates *must* be assembled with all the bolts left loose for final adjustment and positioning (before tightening) unless otherwise instructed. All bolts *must* be torqued for proper strength. If more than one bolt is used per fastening point, the diagram may only show one. Use flat washers over all slotted holes and lock washers on all fasteners.

WARNING

Failure to heed these warnings or follow the installation instructions may result in a voided warranty, loss of towed vehicle, personal injury or death.

- Do not weld or modify this baseplate or its components. Welding or modification will void the warranty.
- Do not use this document as a basis to design/fabricate a baseplate, as it may not show all parts or structural components.
- We strongly recommend professional installation.
- If the towed vehicle has been in an accident, it must be properly repaired before attaching the baseplate. Do not install the baseplate if any structural frame damage is found.
- The installer must use all bolts and parts supplied. If running changes were made by the vehicle manufacturer after this kit was designed, some bolts or other fasteners may no longer be the correct size. It is the installer's responsibility to verify this kit is securely fastened to the vehicle.
- Use Loctite® Red on all bolts used to secure this baseplate. Torque all bolts to the specifications found at the end of these instructions. Do not over-torque the bolts or failure may occur.
- The installer must inspect the baseplate to ensure adequate clearance, particularly around hoses, air conditioner lines, radiators, etc. or non-warranty failure may result.
- Roadmaster manufactures many styles of baseplates. If your baseplate has removable arms, they must be removed before driving the vehicle, unless the arms can be pinned or padlocked in place. If not secured, the arms could vibrate out.
- Some motorhome chassis have such a tight turning radius that you can damage your motorhome, towed vehicle, tow bar or baseplate while turning sharply. Before getting on the road, test your turning radius in an empty parking lot. Turning too sharply could

result in non-warranty damage to your towing system, motorhome and/or towed vehicle.

- Do not back up with the towed vehicle attached or non-warranty damage will occur to your towing system or vehicles.
- The safety cables must connect the towing vehicle to the towed vehicle frame to frame, with the cables crossed, with enough slack for sharp turns. See cable instructions for proper routing. Failure to do so will result in non-warranty damage and/or the loss of the towed vehicle.
- This kit is designed for use with ROADMASTER tow bars and ROADMASTER adapters only. Using this kit with other brands, without an approved ROADMASTER adapter, may result in non-warranty damage or injury.
- Receiver extensions and out-of-level towing situations of 3 inches or more. This can cause the system to swing much higher and lower, causing excessive strain on the tow bar, baseplate and frame. That can cause the towing system to fail, causing property damage, personal injury or even death. If you must use a receiver extension or drop hitch to tow, it will reduce your receiver's weight capacity by 1/3 to avoid damaging your system. Never use more than one extension and/or drop hitch, as this will void your warranty.
- Every 3,000 miles, the owner must inspect all mounting points for cracks or fatigue, and check the fasteners for proper torque, according to the bolt torque requirements chart on the last page of these instructions.
- The owner must follow the vehicle manufacturer's instructions to prepare the vehicle for towing. Failure to do so may cause severe damage to the vehicle.
- This baseplate is only warranted for the original installation. Installing a used baseplate on another vehicle is not recommended and will void the warranty.



BASEPLATE KIT INSTALLATION INSTRUCTIONS

KIT# 1167-1

03/11/08

KS

ROADMASTER, Inc. 6110 NE 127th Ave. Vancouver, WA 98682 1-800-669-9690 fax 360-735-9300 www.roadmasterinc.com

1. This bracket kit is one of our XL series, which is designed to be partly removable (Fig.A). The kit consists of the main receiver brace, two front arm braces, two lower braces and a hardware pack. The main receiver brace mounts behind the front bumper fascia to the inside of the frame. The lower braces attach to the front of the radiator support on each side. The front arm braces insert into the receivers on each side. Start by laying the kit out according to the illustration. This will give you a visual idea of how the kit installs and also confirm that all the components are present and accounted for.

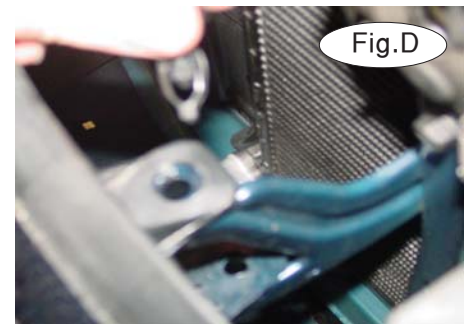
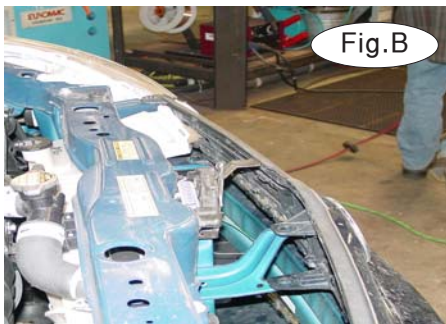

2. **Important:** please use all supplied bolts and parts and read all instructions carefully before beginning this installation. The majority of questions you may have can be answered within the text, and proper installation will ensure safe and secure travel. Now, begin the installation by removing the four plastic fasteners in the top of the front bumper fascia holding the radiator cover (Fig.B,C,D).

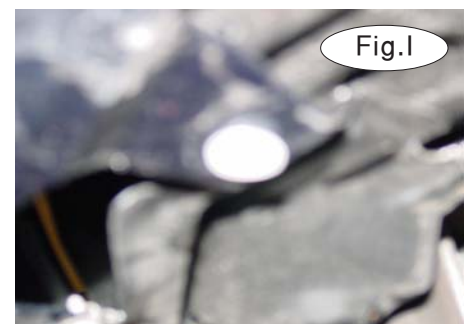

3. Remove an upper fascia Phillips screw at the fascia and fenderwell junction on each side (Fig.E).
4. Move underneath the fascia on each and remove the 10mm (head) lower side fascia screws (Fig.F).
5. Remove four 10mm (head) bolts and two plastic fasteners under the fascia (Fig.G, Fig.H, Fig.I).



BASEPLATE KIT INSTALLATION INSTRUCTIONS

KIT# 1167-1

03/11/08

KS

ROADMASTER, Inc. 6110 NE 127th Ave. Vancouver, WA 98682 1-800-669-9690 fax 360-735-9300 www.roadmasterinc.com



Fig.J



Fig.K

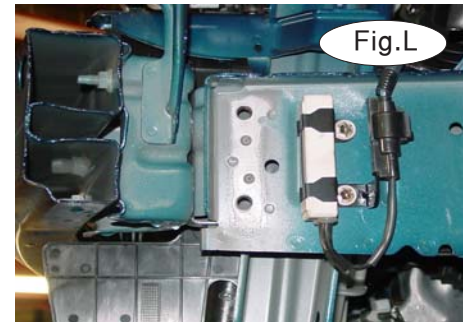

Fig.L

6. Pull forward to remove the fascia and set aside (Fig.J,K).

7. Move to the driver's side of the frame and remove the white ball resistors located on the side of the frame (Fig.L).

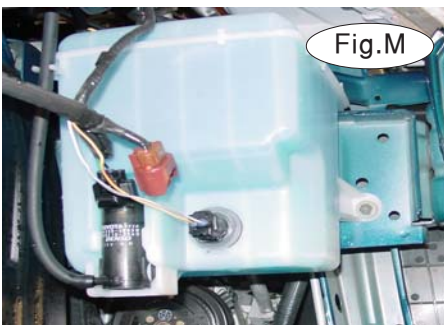

Fig.M

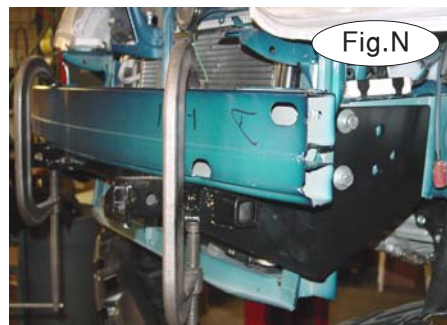

Fig.N

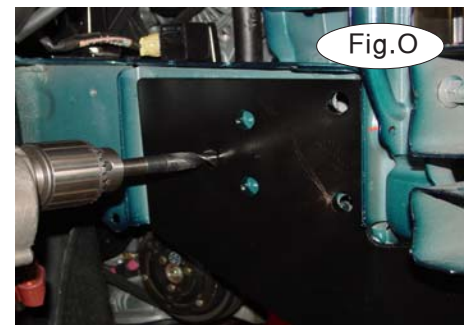

Fig.O

8. On the passenger side disconnect the washer bottle fitting and electrical connections, remove the two 10mm (head) mounting bolts and slide the bottle down and away from the frame. The neck has a small tab that must be disengaged before pulling down (Fig.M).

9. Hold the main receiver brace under the bumper core and bolt through the side front mounting holes with two 10mm x 1.25 x 30mm bolts (Fig.N).

10. Align the receiver brace then clamp to the bottom of the bumper core and tighten the 10mm bolts installed in step 8 to hold the brace in position (Fig.N).

11. Using a 17/32" drill bit, drill through the mounting holes on both sides using the receiver brace as a drill template (Fig.O).

12. Use the same drill bit to drill two holes through the bottom of the bumper core, again using the brace as a template (Fig.P).

13. Remove the receiver brace.

14. Mark for reassembly then remove the bumper core (four 12mm nuts) and set aside (Fig.Q).

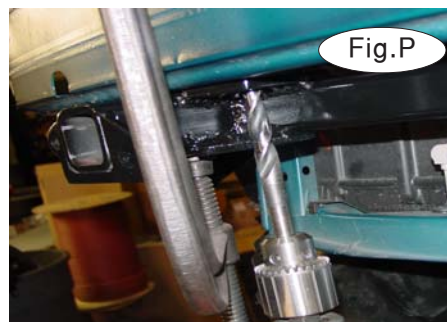

Fig.P

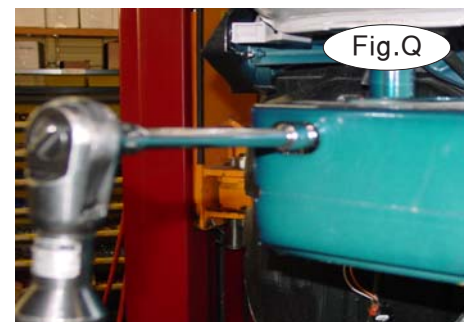

Fig.Q



BASEPLATE KIT INSTALLATION INSTRUCTIONS

KIT# 1167-1

03/11/08

KS

ROADMASTER, Inc. 6110 NE 127th Ave. Vancouver, WA 98682 1-800-669-9690 fax 360-735-9300 www.roadmasterinc.com

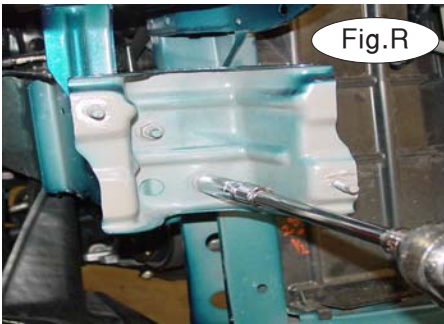

Fig.R

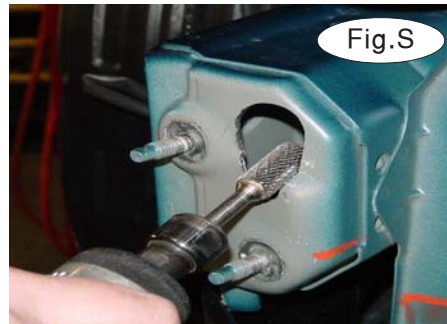

Fig.S

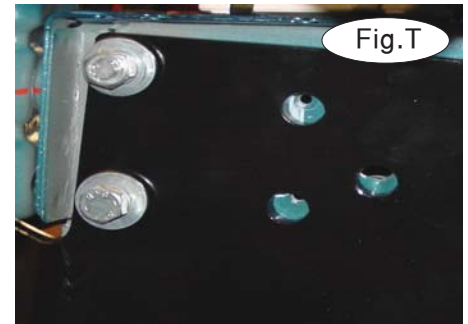

Fig.T

16. Once the bumper core is removed, remove the 12mm bumper core mounting bracket on the passenger side nuts (Fig.R).

17. On the passenger side, enlarge the front access hole enough to allow fishwiring for two $\frac{1}{2}$ " x $1\frac{3}{4}$ " bolts and clipped flat washers (Fig.S).

18. Remount the receiver brace with two 10mm x 1.25 x 30mm bolts, lock washers and fender washers on the drivers side (Fig.T).

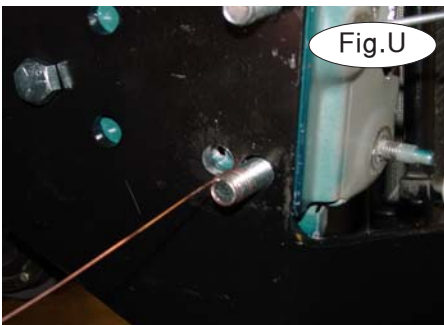

Fig.U



Fig.V

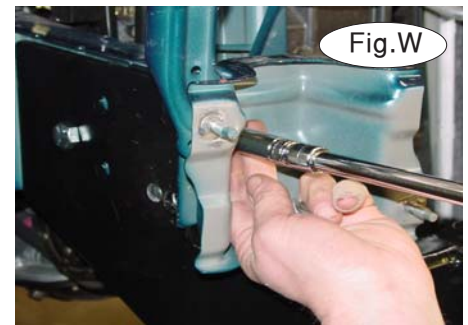

Fig.W

19. Align the passenger side of the brace with the holes drilled in step 11 and fishwire two $\frac{1}{2}$ " x $1\frac{3}{4}$ " bolts and clipped flat washers through the front mounting holes. Bolt through the receiver brace with $\frac{1}{2}$ " nuts and lock washers (Fig.U).

20. Bolt through rear mounting hole on each side with a $\frac{1}{2}$ " x 4" bolt, 2" x 3" backing plate, lock washer and nut. Be sure and use the backing plate on the inside of the frame (Fig.V). *Note:* use caution when working around the air bag sensors located on the inside of the frame.

21. Replace the bumper core mount (Fig.W) then the bumper core (Fig.X).



Fig.X

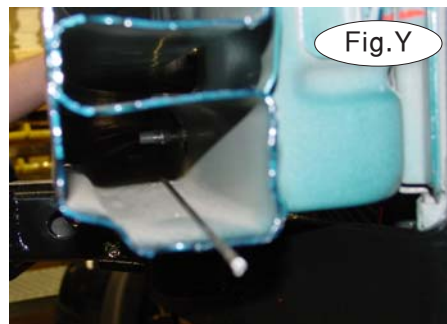

Fig.Y



Fig.Z

22. Insert the $1\frac{1}{4}$ " x 3" threaded backing plates in the ends of the bumper core using the wire handles to position over the holes drilled in step 12 (Fig.Y).

23. Bolt through the receiver brace and bumper core into these backing plates with two $\frac{1}{2}$ " x $1\frac{1}{4}$ " bolts and lock washers (Fig.Z).



BASEPLATE KIT INSTALLATION INSTRUCTIONS

KIT# 1167-1

03/11/08

KS

ROADMASTER, Inc. 6110 NE 127th Ave. Vancouver, WA 98682 1-800-669-9690 fax 360-735-9300 www.roadmasterinc.com

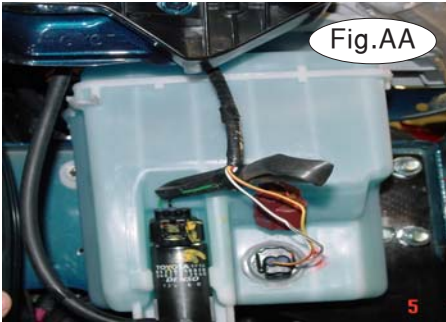

Fig.AA



Fig.BB

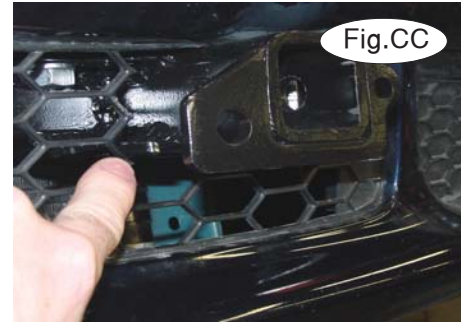

Fig.CC

24. Tighten all mounting bolts to the torque specifications found at the end of these instructions.

25. Reinstall the washer bottle using a 6mm x 1.0 x 25mm bolt, lock washer and fender washer in the front mount (Fig.AA).

26. Reinstall the driver's side resistor block with two 6mm x 1.0 x 25mm bolts, lock washers and fender washers (Fig.BB).

27. Hold the fascia in place and trim the grille to fit around the receivers (Fig.CC).

28. Reinstall the fascia reversing steps 1 through 6.

29. Install the front braces into the receivers and secure with 5/8" draw pins and 3/16" spring pins.

30. Attach the safety cables to front of the receivers with the supplied cable connectors and to the tow vehicle's safety cables (Fig.DD)

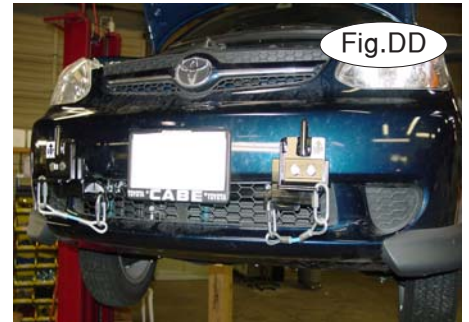

Fig.DD

BOLT TORQUE REQUIREMENTS

Note: The torque values represented below are intended as general guidelines. Torque requirements for specific applications may vary. Roadmaster does not warrant this information to be accurate for all applications and disclaims all liability for any claims or damages which may result from its use.

STANDARD BOLTS

Thread Size	Grade	Torque
5/16	5	13 ft./lb.
3/8	5	23 ft./lb.
7/16	5	37 ft./lb.
1/2	5	56 ft./lb.
5/8	5	150 ft./lb.

METRIC BOLTS

Thread Size	Grade	Plated/Unplated
8mm-1.0	8.8	20 ft./lb. 18 ft./lb.
8mm-1.25	8.8	19 ft./lb. 18 ft./lb.
10mm-1.25	8.8	38 ft./lb. 36 ft./lb.
10mm-1.5	8.8	37 ft./lb. 35 ft./lb.

METRIC BOLTS

Thread Size	Grade	Plated/Unplated
12mm-1.25	8.8	70 ft./lb. 65 ft./lb.
12mm-1.5	8.8	66 ft./lb. 61 ft./lb.
12mm-1.75	8.8	65 ft./lb. 60 ft./lb.
14mm-2.0	8.8	104 ft./lb. 97 ft./lb.

All illustrations and specifications contained herein are based on the latest information available at the time of publication approval. ROADMASTER, INC. reserves the right to make changes at any time without notice in material, specification and models or to discontinue models.