



Tire Carrier Adapter INSTALLATION INSTRUCTIONS

KIT# 195225-550

10/24
RS

ROADMASTER, Inc.

6110 NE 127th Ave.

Vancouver, WA 98682

360-896-0407

www.RoadmasterInc.com

What You'll Need

- General Tools
- Socket wrenches in the following sizes: 3/4"; 13/16"; 7/8"; 15/16"; and 1-1/8"

About this kit

This is for adapting the 195225-S spare tire carrier to allow for a wheel with recessed face to be carried on it.

Need Help? Call Toll-Free

1-800-669-9690

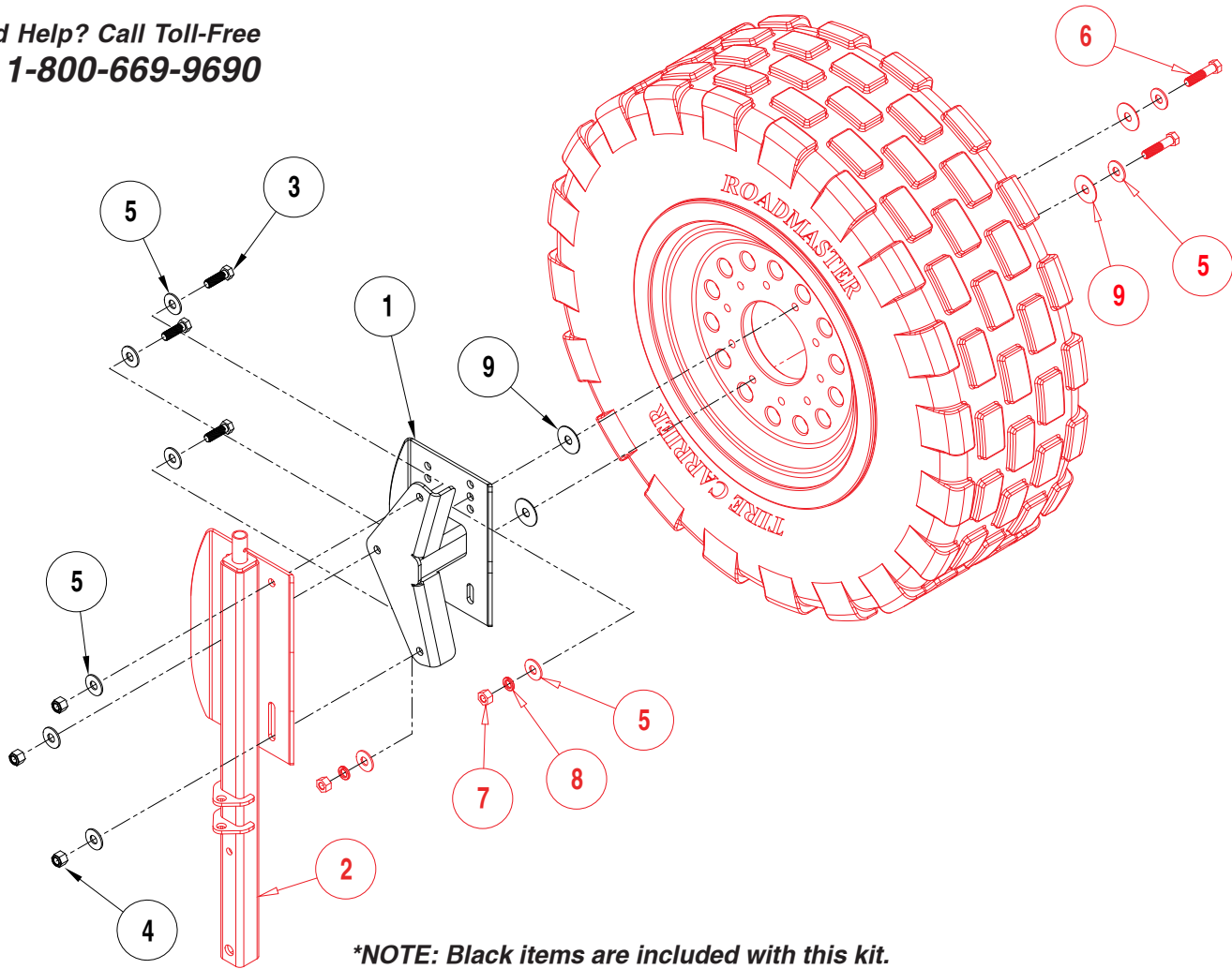

***NOTE: Black items are included with this kit.
Red items are NOT included. Tire not included.**

ITEM	QTY	DESCRIPTION	PART #
1	1	TIRE CARRIER ADAPTOR	C003840
2	1	TIRE CARRIER (From Tire Carrier Kit)*	195225-S
3	3	9/16-12 X 1 3/4" GRADE 5 BOLT	350216-85
4	3	9/16-12 NYLON INSERT LOCK NUT	350261-00
5	6	9/16" USS FLAT WASHER	350347-00
"	4	9/16" USS FLAT WASHER (From Tire Carrier Kit)*	" " " " " "
6	2	9/16-12 X 2 1/2" GRADE 5 BOLT (From Tire Carrier Kit)*	350216-25
7	2	9/16-12 HEX NUT (From Tire Carrier Kit)*	350260-00
8	2	9/16" LOCK WASHER (From Tire Carrier Kit)*	350311-10
9	4	9/16" NYLON WASHER	350372-60
"	2	9/16" NYLON WASHER (From Tire Carrier Kit)*	" " " " " "



Tire Carrier Adapter INSTALLATION INSTRUCTIONS

KIT# 195225-550

10/24
RS

ROADMASTER, Inc.

6110 NE 127th Ave.

Vancouver, WA 98682

360-896-0407

www.RoadmasterInc.com

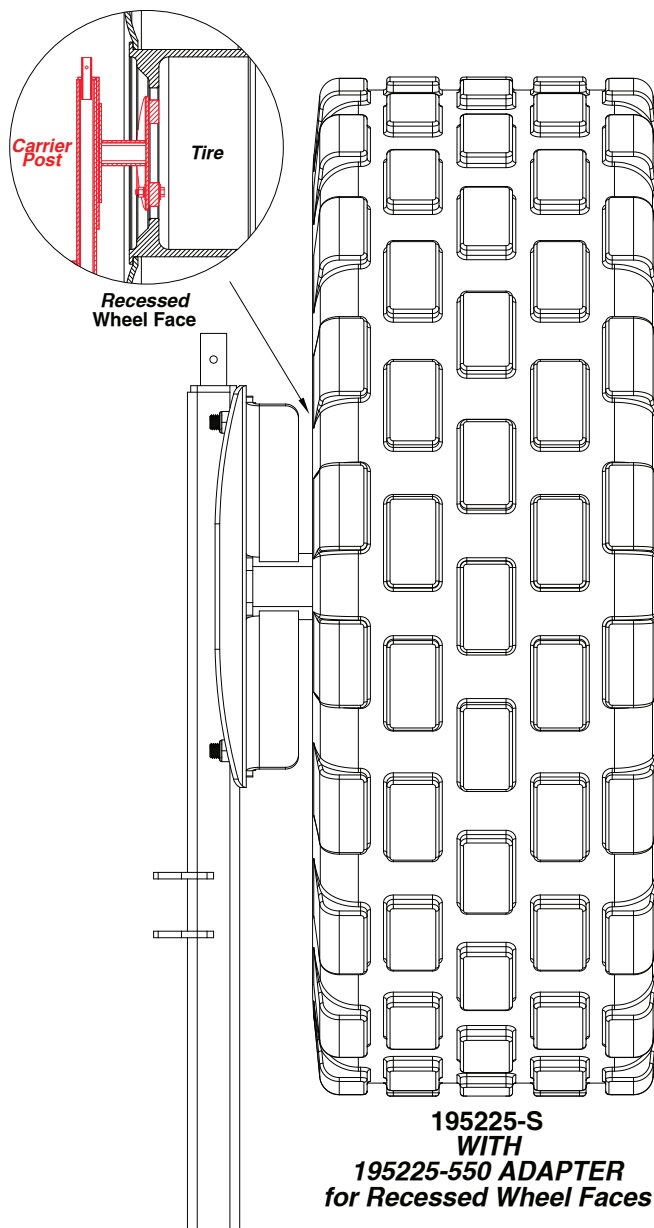
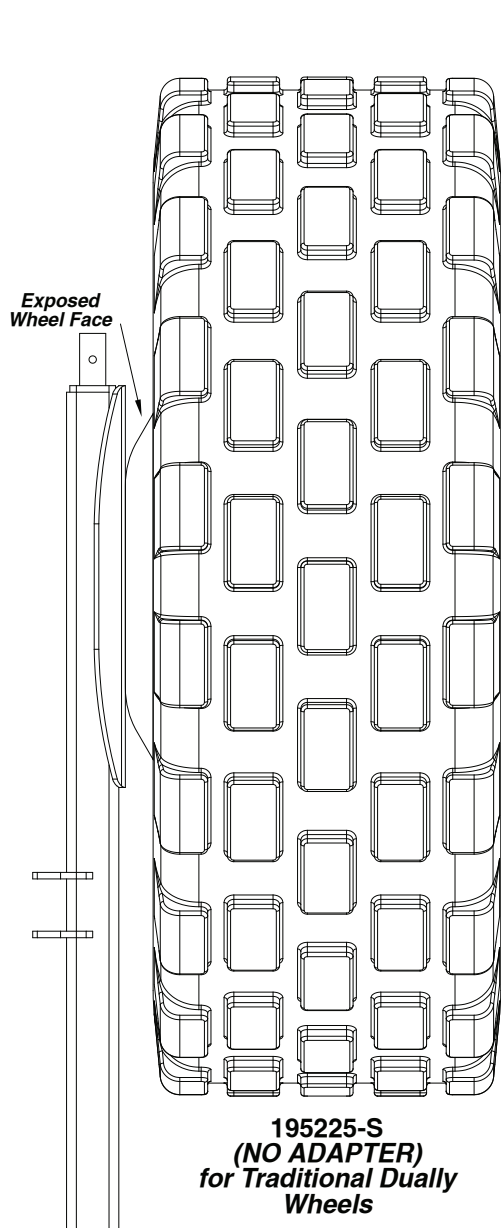

IMPORTANT!

This adapter is for attaching wheels with a recessed face to the tire carrier.
 If you have traditional dually wheels, as shown, do not use this adapter. Using this adapter with a traditional dually wheel can cause damage and void your warranty. Instead simply attach your wheel directly to the carrier.



Tire Carrier Adapter INSTALLATION INSTRUCTIONS

KIT# 195225-550

10/24
RS

ROADMASTER, Inc.

6110 NE 127th Ave.

Vancouver, WA 98682

360-896-0407

www.RoadmasterInc.com

WARNING

Read all instructions before assembling or operating this device. Failure to understand how to properly assemble or operate the spare tire carrier could result in extensive property damage or severe personal injury.

Installation:

1. Install the tire carrier as per the tire carrier instructions before adding the adapter to the carrier.

2. Using the supplied hardware, locate three 9/16" Lock nut, six 9/16" flat washer, and the three 9/16" bolts. As per figure B, relevant hardware shown in red, place the adapter onto the tire carrier, aligning it as shown.

3. Use a bolt followed by a washer and capped with a washer and locknut on the three indicated holes to attach the adapter to the carrier. Figure B2 shows a completed attachment. Confirm that the adapter is secure to the tire carrier, by making sure the bolt torque is 90 ft. lbs.

4. As per the instructions for the tire carrier, swing the tire carrier to the ground. There are several mounting holes in the adapter plate, as shown in figure C and C2. Align at least one of these with your wheel. Attach the wheel to the carrier by using the supplied hardware and hardware from the tire carrier kit: 9/16-12 x 1 3/4" bolt, 9/16" washer, nylon washer, wheel, nylon washer then finished with a 9/16" washer, 9/16" lock washer, and 9/16" hex nut. Finger tighten for now.

5. Now, raise the tire carrier back up and secure the carrier in the upright position as per the tire carrier instructions. Adjust and align the wheel with another hole in the adapter, then repeat the process in step 4 to secure the wheel to the adapter. Figure C shows this setup and figure C2 shows a possible alignment. To secure the wheel completely: torque all bolts to 90 ft. lbs.

6. Be sure to follow all warning and instructions that came with your tire carrier.

