

BASEPLATE KIT INSTALLATION INSTRUCTIONS

ROADMASTER, Inc. 6110 NE 127th Ave. Vancouver, WA 98682 1-800-669-9690 fax 360-735-9300 www.roadmasterinc.com

PARTS LIST:

- 1- MAIN BRACE (A)
- 1- FRONT BRACE (B) - Driver's side
- 1- FRONT BRACE (C) - Passenger side

KIT NO. 169-3

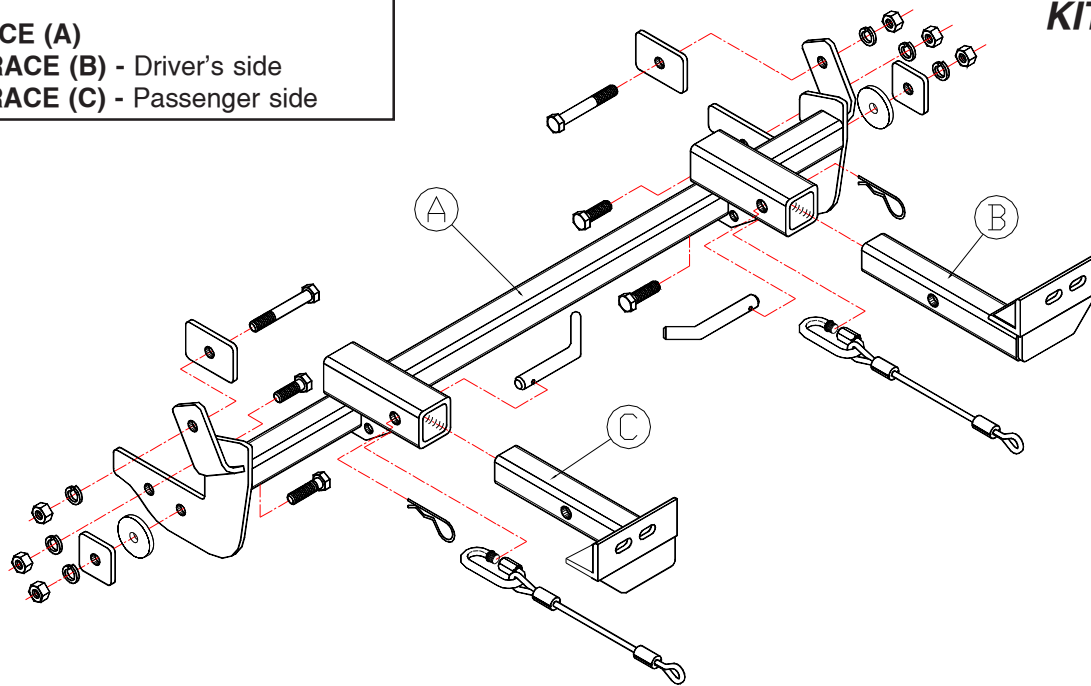

11-18-97

IMPORTANT: All baseplates **must** be assembled with all the bolts left loose for final adjustment and positioning (before tightening) unless otherwise instructed. All bolts **must** be torqued for proper strength. If more than one bolt is used per fastening point, the diagram may only show one. Use flat washers over all slotted holes and lock washers on all fasteners.

WARNING

Failure to heed these warnings or follow the installation instructions may result in a voided warranty, loss of towed vehicle, personal injury or death.

- Do not weld or modify this baseplate or its components. Welding or modification will void the warranty.
- Do not use this document as a basis to design/fabricate a baseplate, as it may not show all parts or structural components.
- We strongly recommend professional installation.
- If the towed vehicle has been in an accident, it must be properly repaired before attaching the baseplate. Do not install the baseplate if any structural frame damage is found.
- The installer must use all bolts and parts supplied. If running changes were made by the vehicle manufacturer after this kit was designed, some bolts or other fasteners may no longer be the correct size. It is the installer's responsibility to verify this kit is securely fastened to the vehicle.
- Use Loctite® Red on all bolts used to secure this baseplate. Torque all bolts to the specifications found at the end of these instructions. Do not over-torque the bolts or failure may occur.
- The installer must inspect the baseplate to ensure adequate clearance, particularly around hoses, air conditioner lines, radiators, etc. or non-warranty failure may result.
- Roadmaster manufactures many styles of baseplates. If your baseplate has removable arms, they must be removed before driving the vehicle, unless the arms can be pinned or padlocked in place. If not secured, the arms could vibrate out.
- Some motorhome chassis have such a tight turning radius that you can damage your motorhome, towed vehicle, tow bar or baseplate while turning sharply. Before getting on the road, test your turning radius in

an empty parking lot. Turning too sharply could result in non-warranty damage to your towing system, motorhome and/or towed vehicle.

- Do not back up with the towed vehicle attached or non-warranty damage will occur to your towing system or vehicles.
- The safety cables must connect the towing vehicle to the towed vehicle frame to frame, with the cables crossed, with enough slack for sharp turns. See cable instructions for proper routing. Failure to do so will result in non-warranty damage and/or the loss of the towed vehicle.
- This kit is designed for use with ROADMASTER tow bars and ROADMASTER adapters only. Using this kit with other brands, without an approved ROADMASTER adapter, may result in non-warranty damage or injury.
- Receiver extensions and out-of-level towing situations of 3 inches or more. This can cause the system to swing much higher and lower, causing excessive strain on the tow bar, baseplate and frame. That can cause the towing system to fail, causing property damage, personal injury or even death. If you must use a receiver extension or drop hitch to tow, it will reduce your receiver's weight capacity by 1/3 to avoid damaging your system. Never use more than one extension and/or drop hitch, as this will void your warranty.
- Every 3,000 miles, the owner must inspect all mounting points for cracks or fatigue, and check the fasteners for proper torque, according to the bolt torque requirements chart on the last page of these instructions.
- The owner must follow the vehicle manufacturer's instructions to prepare the vehicle for towing. Failure to do so may cause severe damage to the vehicle.
- This baseplate is only warranted for the original installation. Installing a used baseplate on another vehicle is not recommended and will void the warranty.

BASEPLATE KIT INSTALLATION INSTRUCTIONS

ROADMASTER, Inc. 6110 NE 127th Ave. Vancouver, WA 98682 1-800-669-9690 fax 360-735-9300 www.roadmasterinc.com

KIT NO. 169-3

1. **Important:** please use all supplied bolts and parts and read all instructions carefully before beginning this installation. The majority of questions you may have can be answered within the text, and proper installation will ensure safe and secure travel. Now, begin the installation. This bracket kit utilizes the lower tie down plates and the front frame as mounting points. It is a quick disconnect or XL Series kit comprised of the main lower brace which mounts behind the bumper and two upper braces which can be removed from the main brace. The bumper will have to be removed to install the main brace.
2. Remove two screws from the head lights and loosen. Remove the center screw behind the bumper in front of the radiator and two screws per side in the fender wells.
3. Now, remove the front bumper mounting bolt on each side, then loosen the side mounting bolts. Pull the bumper forward and off the car.
4. Locate the radiator overflow container on the drivers side and remove the two lower bolts holding it in position. Pull the container off the top mounting grommet to provide access to the inside of the frame.
5. Take the main receiver brace and hold between the tie down plates, with the upper tabs to the outside of the frame, bolt through the tie downs on each side with 1/2" x 1 3/4" bolts, 2" x 2" backing plates, lock washers and nuts. *Note:* on some models there may be a gap between the main receiver and the tie down. If so, install the 1/2" plate washer included in the bolt kit as an optional shim to take up any gaps between the bracket and the tie down plate. Align the brace so the receiver tubes are horizontal and tighten the bolts.
6. Using the brace as a template, drill a 1/2" hole through the outside wall of the frame on each side. Bolt through the frame and brace on each side using a 1/2" x 3 1/2" bolt, a 1/4" x 2" x 3" backing plate, lock washer and nut. *Note:* bolt from the inside of the frame with the backing plate covering the large frame hole.
7. Using the brace as a template, drill another hole through each tie down and bolt using a 1/2" x 1 1/2" bolt, lock washer and nut on each side.
8. Torque all bolts to the specifications below, then replace the radiator container using a 1/2" nut as a spacer and a 8mm x 1.25 x 40mm bolt and lock washer.
9. Install the bumper, reversing the steps outlined in steps 2 and 3. *Note:* on some models the grille strip will have to be displaced downward to clear the brace. Torque all bolts to the specifications below.
10. Once the bumper is installed, slip the front braces into the receiver tubes with the front mounting angles pointing away from each other as illustrated. Insert the draw pins and secure with the provided spring pins.
11. Mount the tow bar according to the manufacturers instructions.
12. Attach the towing cables to the lower receivers with the provided quick links. A hole is provided under neath each receiver tube for this purpose.

11-18-97

BOLT TORQUE REQUIREMENTS

Note: The torque values represented below are intended as general guidelines. Torque requirements for specific applications may vary. Roadmaster does not warrant this information to be accurate for all applications and disclaims all liability for any claims or damages which may result from its use.

STANDARD BOLTS			METRIC BOLTS			METRIC BOLTS		
Thread Size	Grade	Torque	Thread Size	Grade	Plated/Unplated	Thread Size	Grade	Plated/Unplated
5/16	5	13 ft./lb.	8mm-1.0	8.8	20 ft./lb. 18 ft./lb.	12mm-1.25	8.8	70 ft./lb. 65 ft./lb.
3/8	5	23 ft./lb.	8mm-1.25	8.8	19 ft./lb. 18 ft./lb.	12mm-1.5	8.8	66 ft./lb. 61 ft./lb.
7/16	5	37 ft./lb.	10mm-1.25	8.8	38 ft./lb. 36 ft./lb.	12mm-1.75	8.8	65 ft./lb. 60 ft./lb.
1/2	5	56 ft./lb.	10mm-1.5	8.8	37 ft./lb. 35 ft./lb.	14mm-2.0	8.8	104 ft./lb. 97 ft./lb.
5/8	5	150 ft./lb.						



BASEPLATE KIT INSTALLATION INSTRUCTIONS

ROADMASTER, Inc. 6110 NE 127th Ave. Vancouver, WA 98682 1-800-669-9690 fax 360-735-9300 www.roadmasterinc.com

KIT NO. 169-3

HARDWARE LIST:

- 2-1/2" X 3 1/2" BOLTS
- 2-1/2" X 1 3/4" BOLTS
- 2-1/2" X 1 1/2" BOLTS
- 6-1/2" LOCK WASHERS
- 7-1/2" NUTS
- 2-1/4" X 2" X 2" BACKING PLATES
- 2-1/4" X 2" X 3" BACKING PLATES
- 1-8MM X 1.25 X 40MM BOLT
- 1-8MM LOCK WASHER
- 2-QUICK LINKS
- 2-5/8" DRAW PINS
- 2-1/8" SPRING PINS
- 2-10" SAFETY CABLES
- 2-1/2" PLATE WASHERS

11-18-97

BOLT TORQUE REQUIREMENTS

Note: The torque values represented below are intended as general guidelines. Torque requirements for specific applications may vary. Roadmaster does not warrant this information to be accurate for all applications and disclaims all liability for any claims or damages which may result from its use.

STANDARD BOLTS

Thread Size	Grade	Torque
5/16	5	13 ft./lb.
3/8	5	23 ft./lb.
7/16	5	37 ft./lb.
1/2	5	56 ft./lb.
5/8	5	150 ft./lb.

METRIC BOLTS

Thread Size	Grade	Plated/Unplated
8mm-1.0	8.8	20 ft./lb. 18 ft./lb.
8mm-1.25	8.8	19 ft./lb. 18 ft./lb.
10mm-1.25	8.8	38 ft./lb. 36 ft./lb.
10mm-1.5	8.8	37 ft./lb. 35 ft./lb.

METRIC BOLTS

Thread Size	Grade	Plated/Unplated
12mm-1.25	8.8	70 ft./lb. 65 ft./lb.
12mm-1.5	8.8	66 ft./lb. 61 ft./lb.
12mm-1.75	8.8	65 ft./lb. 60 ft./lb.
14mm-2.0	8.8	104 ft./lb. 97 ft./lb.

All illustrations and specifications contained herein are based on the latest information available at the time of publication approval. ROADMASTER, INC. reserves the right to make changes at any time without notice in material, specification and models or to discontinue models.